

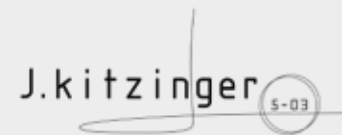

# LAVILLA

design by



enabled by



engineered by



Jérémy Kitzinger  
Designer



James Roy  
Lateral Naval Architects

Home is where the heart is, where families are born and memories created. A place of security and comfort, a place to have fun, to laugh, and cry. A place for families to enjoy time together, yet a place to enjoy solitude and calm. A place to relax, have fun, be creative, and a place to work.

Family life is dynamic and flowing.

The inspiration behind LAVILLA is conceived by Jeremy Kitzinger in collaboration with Lateral Naval Architects. Enabled by Oceanco on their DP061 platform, LAVILLA is developed with two driving forces in mind; Flow & Family.

Designed from the inside out, LAVILLA offers a new-found flow to superyacht living space, providing uninterrupted views and open floors connecting decks and people no matter where you may be.

While many superyacht concepts start life as artistic lines, LAVILLA began as a simple block. Going back the basic design principles, LAVILLA was designed using golden ratios and step-by-step layout development to form and shape the perfect platform for expansive space, unbreakable lines of sight, while still possessing a sense of togetherness.

LAVILLA, your home away from home.



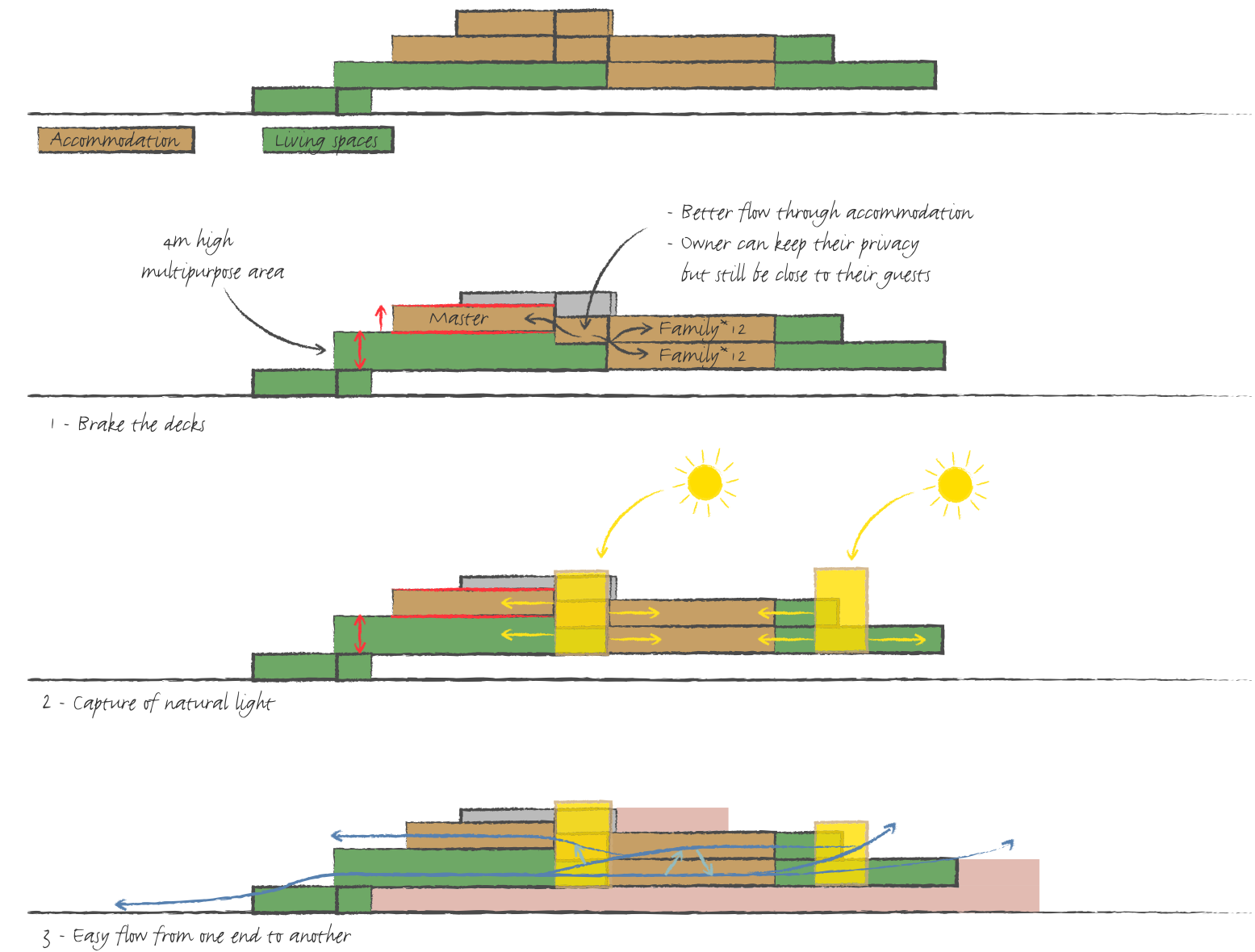
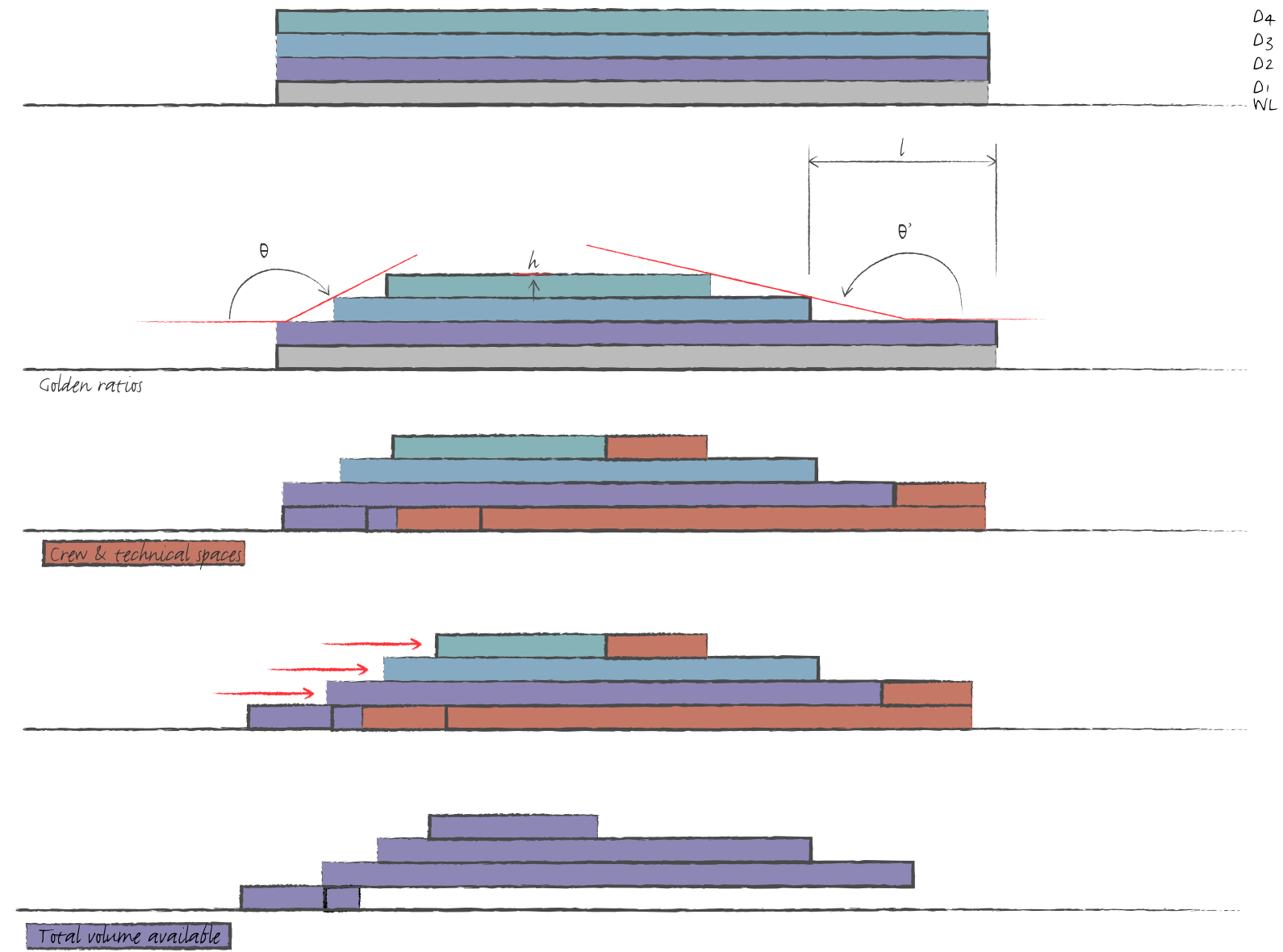



LAVILLA is developed around how time is spent together, and how time needs to be spent apart, young and old, work and play. Featuring both fun and formal spaces LAVILLA has something for everyone in the family, a true home away from home.





LAVILLA  
features a grand  
central atrium

With a grand central atrium, touching 9m in height, open ceilings throughout the accommodation and an open forward garden on the main deck, LAVILLA offer's natural incoming light amongst the living spaces, creating a warm feel in every area.







LAVILLA features a 4m high, multipurpose, open plan living space

Boasting a full deck dedicated to the owner's family in addition to creative space, adaptable multipurpose areas and an open plan living area featuring a 4m height ceilings and an open family kitchen, all opening onto an 8m swimming pool.

With 2 Family Suites, 1 kids' bunkroom and up to 11 Family/Friends cabins, LAVILLA can welcome up to 24 guests, more than enough for friends and family to visit and experience LAVILLA.





An architectural rendering of a modern yacht deck, specifically the upper level. The deck is made of light-colored wood planking and features two large, built-in L-shaped seating areas with light grey cushions and dark grey throw pillows. A central walkway leads towards a glass-enclosed cabin structure. Above the deck, a large, flat, dark brown overhang is supported by several thick, cylindrical metal pillars. In the background, the sea is visible under a clear sky. The overall design is minimalist and functional, emphasizing open space and seamless transitions between different levels of the yacht.

LAVILLA  
has been developed  
without corridors

The entire living space has been developed without corridors and studied to offer a perfect continuity from the lower deck to the upper deck. Find yourself leaving the beach club after a swim with the children, walking seamlessly to the foredeck to where you can unwind.



# LAVILLA features its own watersports club

LAVILLA's extensive Watersport Club is filled with an array of toys; Optimist dinghies for the kids and racing Cats for the adults, scuba diving, kitesurfing, paddle boarding and more, so even though the captaining of your floating home is taken care of, you can set sail with the whole family.

On her sky deck, Lavilla has a half-court sports field, along with an infinity jacuzzi to unwind. There is also a fully equipped gym and spa on the lower deck.



LAVILLA's exterior is inspired  
by modern architectural forms...

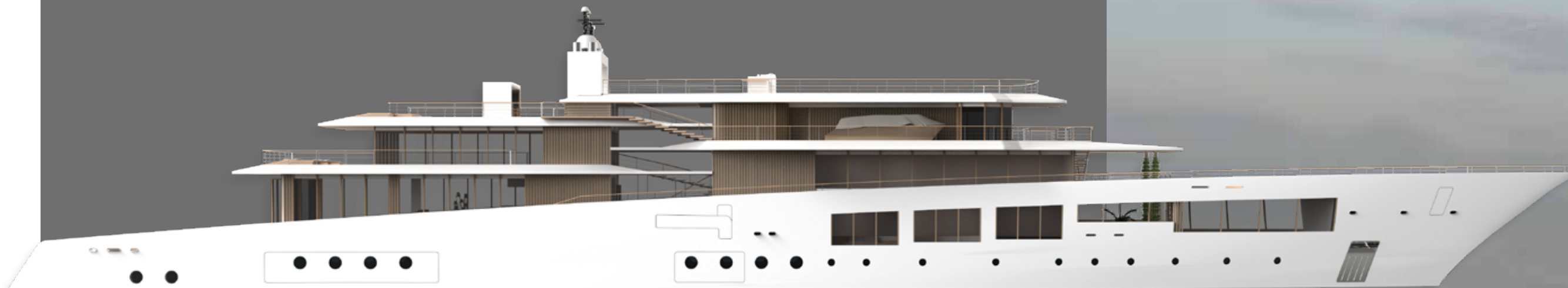

...yet incorporates the elegance of a more classical flowing shearline, which sinks its teeth into the ocean astern and finishes on the lip of the foredeck, offering a unique profile.

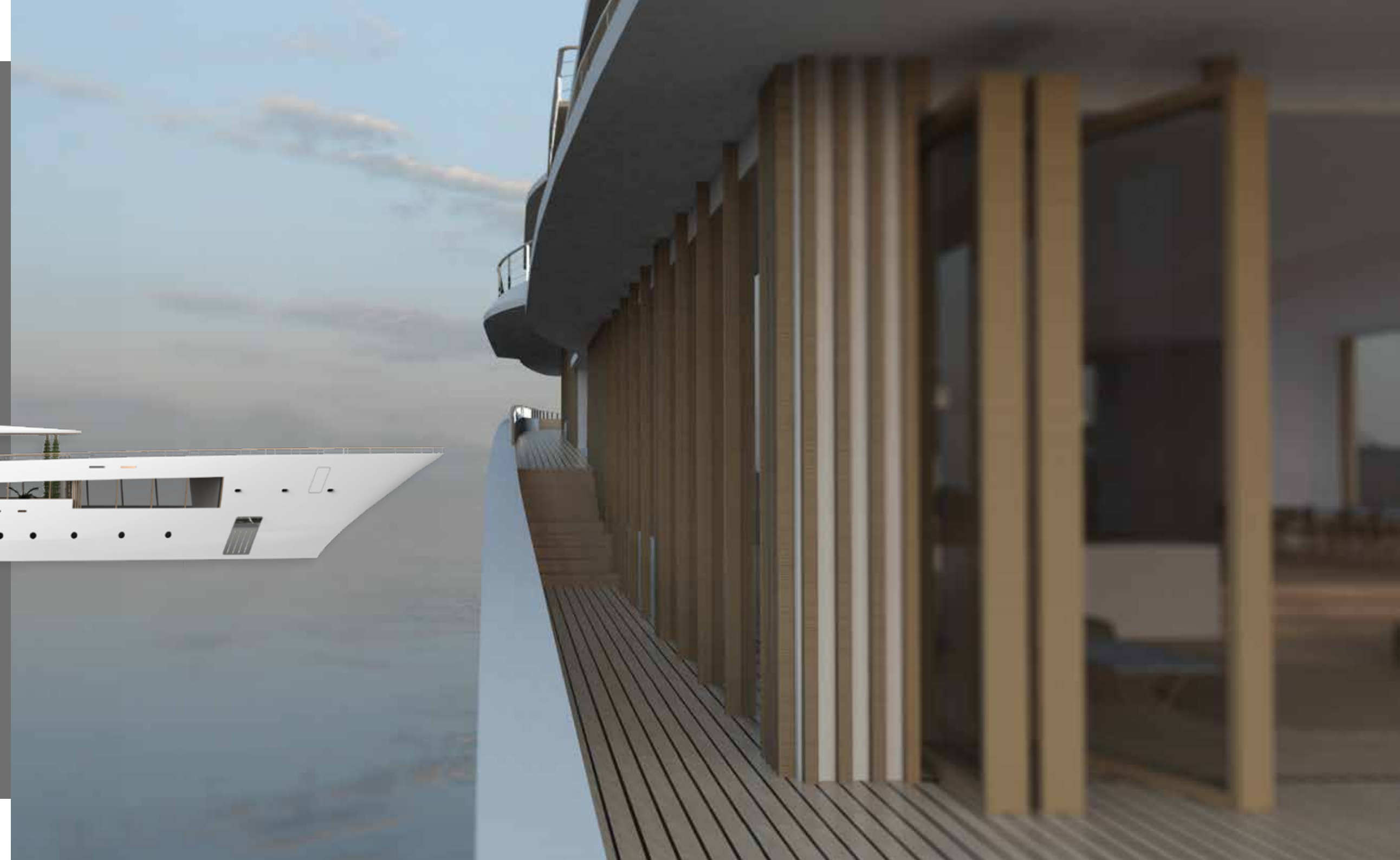





## **oceAnco DP061**

LAVILLA is enabled by Oceanco's extensively optimised and pre-engineered DP061 technical platform with naval architecture by Lateral.

Offering a 20.5 knot maximum speed and transpacific range and endurance at cruising speed DP061 is developed to the highest standards of safety demanded by the REG Yacht Code Part B (Passenger Yacht Unrestricted), providing the perfect technical platform to enable LAVILLA.



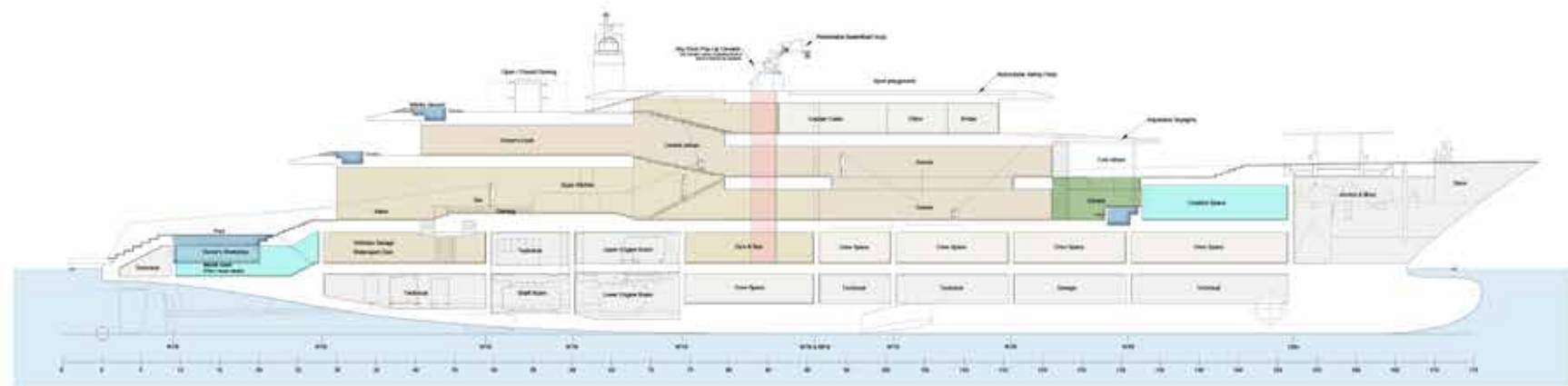

Centerline Section

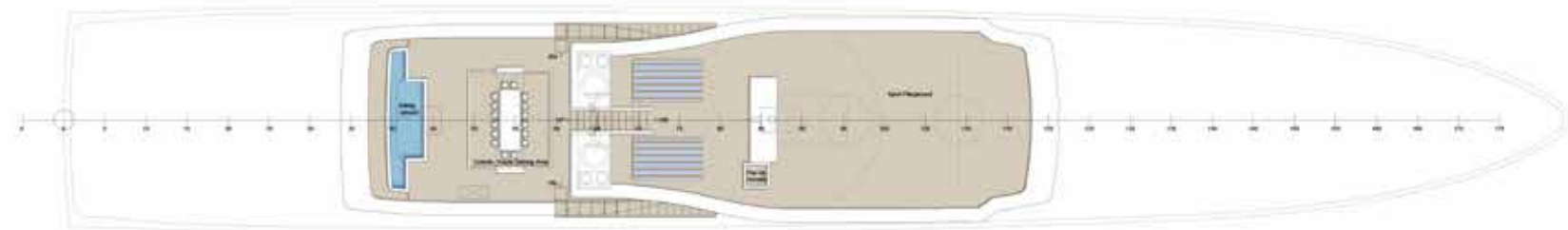

Sky Decks

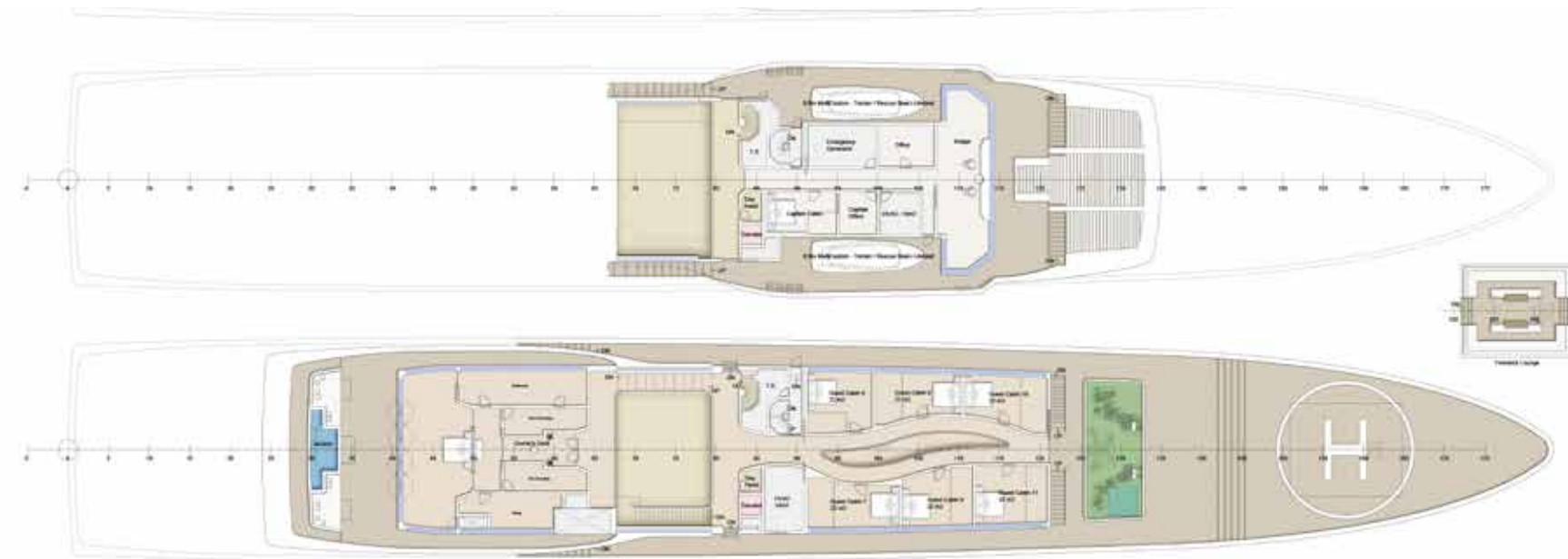

Bridge Deck

Upper Deck



Main Deck



Lower Deck

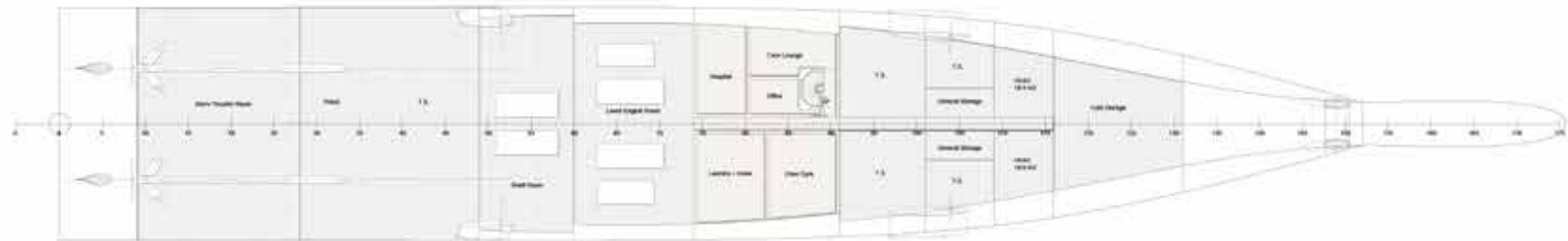

Tank Deck



Length Overall	105.0m
Length Waterline	96.0m
Beam	16.5m
Draught (Half Load)	4.55m
Gross Tonnage	4500
Maximum Speed	20.5knots
Efficient Cruise	14.0knots
Range	5000nm
Main Propulsion Engines	2 x MTU 20V4000 M73L @ 3540kW
Generator Package	2 x 16V2000 M51A @ 620ekW 2 x 12V2000 M41A @ 550ekW
Class	✠I00 AI Passenger Ship ✠LMC UMS ECO
Notation	CISR REG Yacht Code Part B, PY-Unrestricted





LAVILLA